

PART LIST		
PART NUMBER	QTY	PART NAME
1	1	X-Hub Road Front bearing preload system
2	6	15x24x5 bearing (61802-2RS1)
3	2	X-Hub Road 20/28 holes flange
5	1	X-Hub Road front axle end
6	1	X-Hub Road front axle
7	1	X-Hub Road Tube

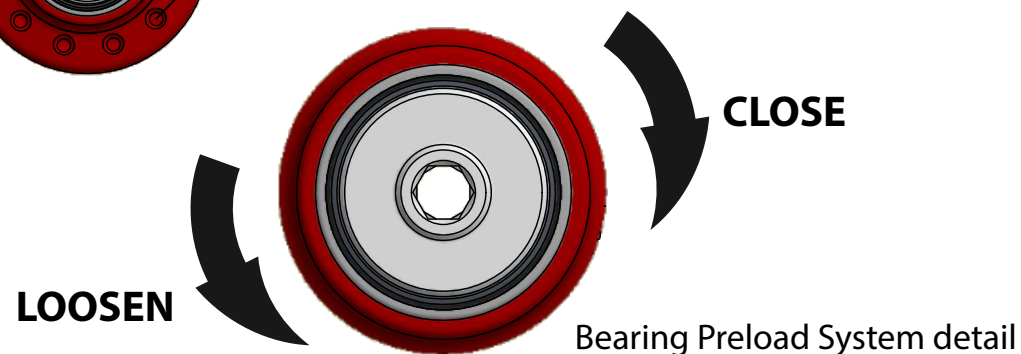

#### BEARING PRELOAD SYSTEM TUNING (BPS)

The external Bearing Preload System is operable with only two fingers. Never use pliers or other tools. The hub comes perfectly tuned from the factory so do not modify the preload if not necessary. The preload adjustment may be needed when the wheel properly installed in the fork has an evident side play or the rotation not is enough smooth. In the first case turn the Bearing Preload System (BPS) in a clockwise direction, in the second case turn counterclockwise direction. The setting is optimal when the wheel does not have any evident side play and rolls very smoothly. Improper adjustment of the BPS however could adversely affect the performance of the hub and damage the bearings. If the adjustment of the BPS is not enough to recover the full efficiency of the hub it is advisable to replace the bearings. This work must be done only by skilled mechanics using original Carbon-Ti spare parts.

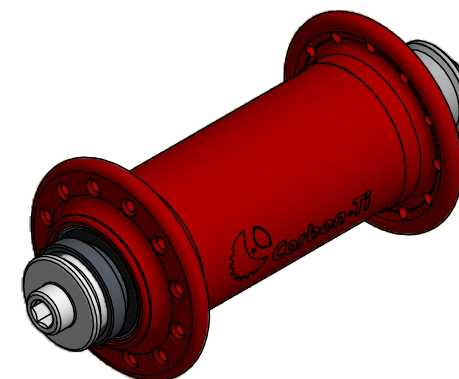
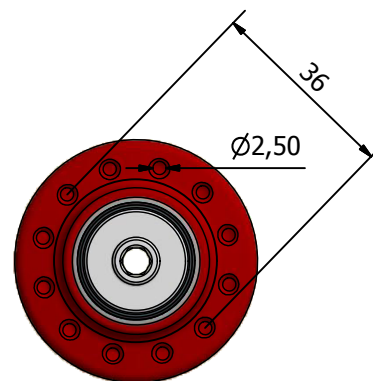
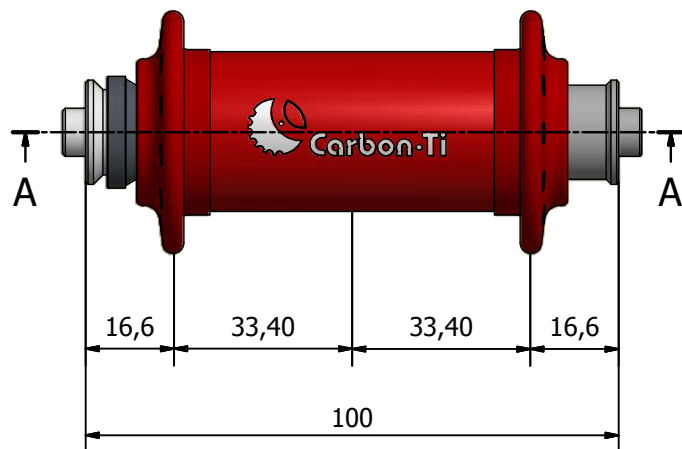

**Carbon-Ti**

**X-HUB ROAD FRONT**

**Instruction Manual**

Made in Italy